



EXCELLENCE IN MEDICAL FURNITURE



When it comes to healthcare spaces,
Esthetica is the name to trust!

Esthetica Chemotherapy Chair is thoughtfully engineered to provide exceptional comfort and clinical support during prolonged chemotherapy and oncology infusion sessions. Designed for cancer care centres, oncology day-care units, infusion clinics, and dialysis centres. This chair combines advanced motorised positioning with patient-focused ergonomics to ensure safe, stable, and stress-free treatment delivery.

**5
MOTORS**



KEY FEATURES



Electronic footrest adjustment

Allowing nursing staff to position patients easily with the push of a button. This eliminates the need for manual force required in conventional chairs, reducing physical strain on caregivers and enabling faster, smoother adjustments during treatment.

Four pre-set positions

End Of Treatment, Trendelenburg, CPR, and Consultation Position. These positions allow medical staff to quickly adjust the chair according to clinical needs, improving workflow efficiency and ensuring patient safety during procedures or emergencies.



Detachable mattress

Quickly removed for cleaning and disinfection. This supports better infection control and simplifies maintenance. After 2-3 years of use, hospitals can replace only the mattress instead of the entire chair.

Phthalate-Free Upholstery

Phthalate-Free Upholstery is designed for hospital environments, offering a safer surface for patients and healthcare workers. It resists stains and disinfectants, withstands frequent cleaning, and ensures durable, fire- and abrasion-resistant performance.



FEATURES

Armrests
Backrest
Legrest
Foot Rest
Height
Trendelenburg
Mattress
Castors

Memory Positions

Adjustable Armrest with Back & Forth and Up - Down Movements
Electronically Adjustable
Electronically Adjustable
Electronically Adjustable
Electronically Adjustable
Removable mattress for easy cleaning and disinfection
100 mm high grade synthetic, single wheel castors, four with brakes



End of Treatment



Trendelenburg



CPR



Consultation

TECHNICAL SPECIFICATIONS

Length 2140 mm / 84.25 in
Extended Length 2280 mm / 89.76 in
Width 850 mm / 33.46 in
Minimum Height 580 mm / 22.83 in
Maximum Height 780 mm / 30.7 in

ELECTRICAL PARAMETERS

Power in (Mains Power Supply) 100–240V, 50–60Hz, 3A
Batteries Optional
IPX Rating IPX6
Operating Temperature 10–40°C
Shock Protection: Class I

ADD-ON ACCESSORIES

Stainless steel IV stand
ABS food tray
IPad/Mobile Stand — Adjustable height and angle, positionable on either side
Dual power socket panel for charging laptops, tablets, and phones

BASE & FRAME

Base Powder-coated mild steel frame
Safe Working Load 175 kgs
Patient Load Bearing capacity 150 kgs

SAFETY STANDARDS

General safety for medical electrical equipment IEC 60601-1 (under process)
EMI/EMC IEC 60601-2 (under process)

UPHOLSTERY

Type Veridura Phthalate-Free Upholstery
Thickness 1 mm
Tensile Strength ISO 1421, 869.22 N/ 5 cm
Colour Options Cream, Beige, Brown, Mouse Grey
Weight 726.7 g / sqmt
Abrasion ISO 5470-2 = 2,00,000 cycles / min

Features :



Phthalate-Free



Fire Retardant



Oil Resistant



Alcohol Resistant



Ultra Soft



Stain Resistant



Anti Bacterial



Eco-Friendly

WARRANTY

3 years on motors



HANDSET

The Esthetica Dialysis Chair is designed to provide dependable comfort, safety, and support for patients during long haemodialysis sessions while ensuring smooth and reliable operation in clinical environments. With ergonomic positioning, robust construction, and user-friendly controls, it supports efficient clinical workflows while maintaining optimal patient comfort throughout treatment.



KEY FEATURES



Electronic Footrest Adjustment

Allowing nursing staff to position patients easily with the push of a button. This eliminates the need for manual force required in conventional chairs, reducing physical strain on caregivers and enabling faster, smoother adjustments during treatment.

Two Pre-Set Positions & Quick Release Function

End of Treatment and Trendelenburg and a quick-release backrest enable medical staff to rapidly adjust the chair according to clinical needs, improving workflow efficiency and ensuring patient safety during procedures or emergencies.



Lifting Column

A 3-segment lifting column provides greater height adjustment, improved stability, and smoother, quieter motion than a linear actuator. Its telescopic design saves space while offering higher lifting capacity and better static and bending load performance.

Phthalate-Free Upholstery

Phthalate-Free Upholstery is designed for hospital environments, offering a safer surface for patients and healthcare workers. It resists stains and disinfectants, withstands frequent cleaning, and ensures durable, fire- and abrasion-resistant performance.

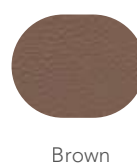
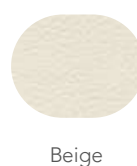
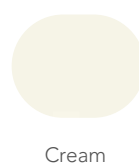

FEATURES

Armrests
Backrest
Legrest
Foot Rest
Height
Trendelenburg
Castors

Memory Positions

Adjustable Armrest with Back & Forth and Up - Down Movements
Electronically Adjustable
Electronically Adjustable
Electronically Adjustable
Electronically Adjustable
Integrated with Legrest
100 mm high grade synthetic, single wheel castos, four with brakes



End of Treatment



CPR

TECHNICAL SPECIFICATIONS

In Flat Bed Position:

Length 1890 mm / 74.4 in
Width without side armrests 560 mm / 22 in
Width with side armrests 830 mm / 32.67 in
Minimum height 550 mm / 21.65 in
Maximum height 850 mm / 33.46 in

ELECTRICAL PARAMETERS

Power in (Mains Power Supply) 100–240V, 50–60Hz 1.5A
IPX Rating IPX6
Operating Temperature 10–40°C
Shock Protection: Class I

ADD-ON ACCESSORIES

Stainless steel IV stand
ABS food tray
IPad/Mobile Stand — Adjustable height and angle, positionable on either side
Dual power socket panel for charging laptops, tablets, and phones

BASE & FRAME

Base Powder-coated mild steel frame
Safe Working Load 150 kgs
Patient Load Bearing capacity 135 kgs

SAFETY STANDARDS

General safety for medical electrical equipment IEC 60601-1
EMI/EMC IEC 60601-2

UPHOLSTERY

Type Veridura Phthalate-Free Upholstery
Thickness 1 mm
Tensile Strength ISO 1421, 869.22 N/ 5 cm
Colour Options Cream, Beige, Brown, Mouse Grey
Weight 726.7 g / sqmt
Abrasion ISO 5470-2 = 2,00,000 cycles / min

Features :



Phthalate-Free



Fire Retardant



Oil Resistant



Alcohol Resistant



Ultra Soft



Stain Resistant



Anti Bacterial



Eco-Friendly

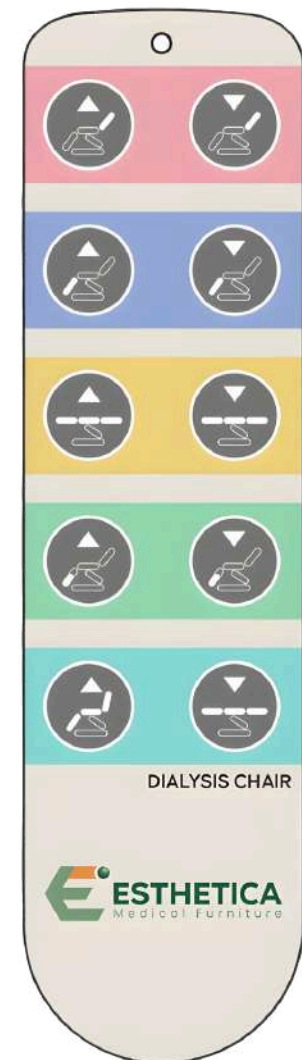

DIALYSIS CHAIR

HANDSET

ESTHETICA
Medical Furniture

WARRANTY

3 years on motors

The Mridul Derma Chair by Esthetica is a professional dermatology chair designed to elevate clinical efficiency and patient comfort. It features a five-piece fully articulated top for superior positioning and versatility. Electrically adjustable height, backrest, leg rest, and tilt functions allow precise control during procedures. Detachable armrests, headrest, and foot section provide added flexibility, making it ideal for modern dermatology and aesthetic practices seeking reliability and advanced functionality.



KEY FEATURES

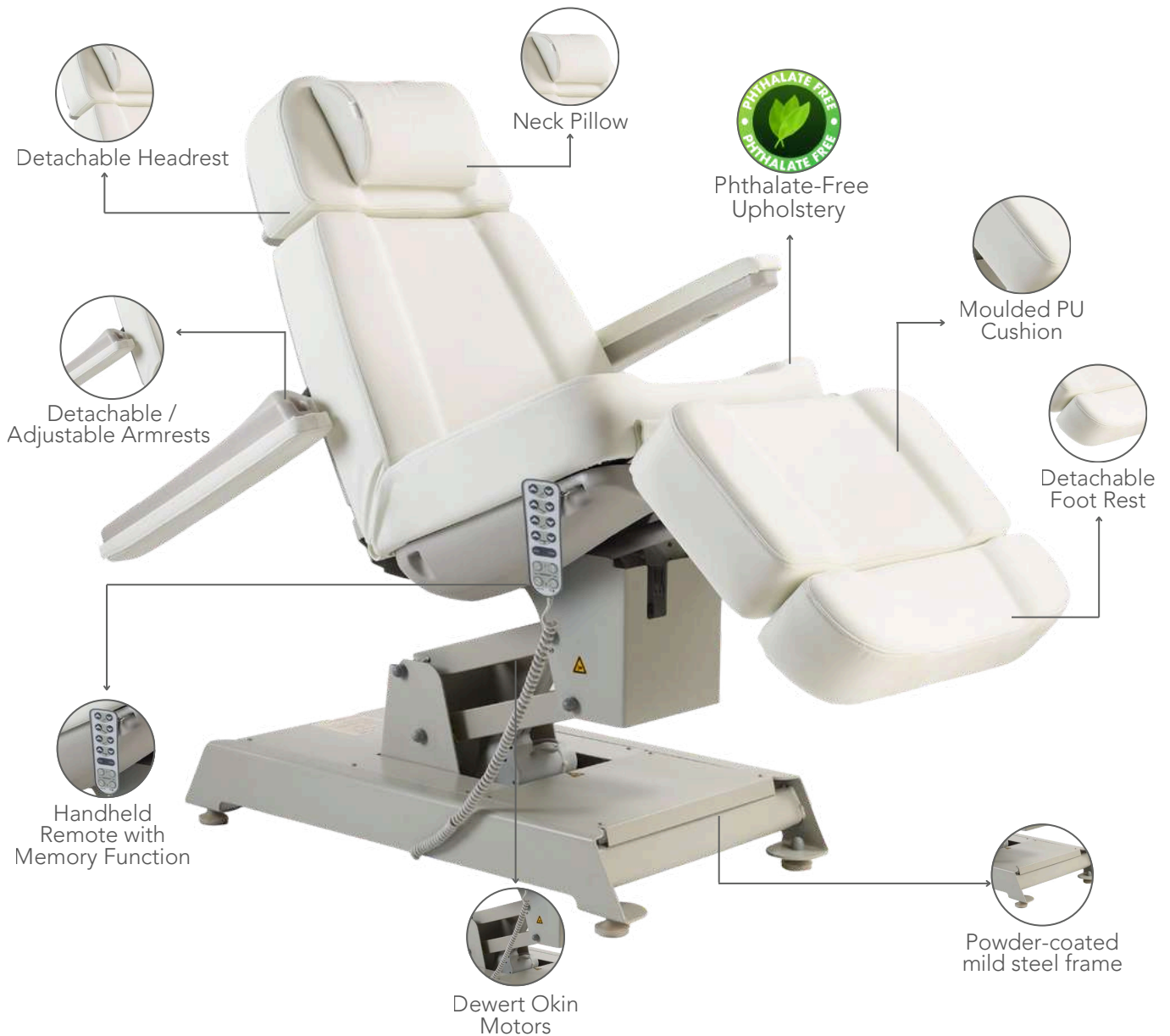

Tilt Function

Mridul Derma Chair's tilt function allows the seat and backrest to move simultaneously, enabling patients to recline comfortably without back pressure—ideal for long treatments while maintaining a stable, ergonomic position.

Programmable Handset

The Mridul Derma Chair's programmable handset stores three doctor-defined positions. With one touch, the chair returns to a saved setting, saving time and allowing positions to be recalled repeatedly during procedures.



Detachable Design

This dermatology chair features removable headrest, leg rest, and armrests, enabling flexible configurations to support diverse treatments, including trichology, foot care, and various skin procedures with enhanced convenience and adaptability.

Phthalate-Free Upholstery

Phthalate-Free Upholstery is designed for hospital environments, offering a safer surface for patients and healthcare workers. It resists stains and disinfectants, withstands frequent cleaning, and ensures durable, fire- and abrasion-resistant performance.



FEATURES

Armrests
Backrest
Headrest
Legrest
Foot Rest
Height
Trendelenburg
Foam Cushion

Programable Handset

Detachable and Adjustable armrests with forward-backward and up-down movement
Electronically Adjustable
Detachable Headrest for flexible treatment
Electronically Adjustable
Detachable Foot Rest
Electronically Adjustable
Electronically Adjustable
75 mm mixed layer for comfortable seating



TECHNICAL SPECIFICATIONS

Length 1880 mm / 74 in
Width without side armrests 630 mm / 24.8 in
Width with side armrests 840 mm / 33 in
Minimum height 630 mm / 24.8 in
Maximum height 850 mm / 33.46 in
Tilt Angle -20°

ELECTRICAL PARAMETERS

Power in (Mains Power Supply) 100-240 V, 50-60HZ, 1.5 A
IPX Rating IPX 6
Operating Temperature 10-40°C
Shock Protection Class I

BASE & FRAME

Base Powder-coated mild steel frame
Safe Working Load 180 kgs
Patient Load Bearing capacity 150 kgs

SAFETY STANDARDS

General safety for medical electrical equipment IEC 60601-1
EMI/EMC IEC 60601-2

UPHOLSTERY

Type Veridura Phthalate-Free Upholstery
Thickness 1 mm
Tensile Strength ISO 1421, 869.22 N/ 5 cm
Colour Options Cream, Beige, Brown, Mouse Grey
Weight 726.7 g / sqmt
Abrasion ISO 5470-2 = 2,00,000 cycles / min

Features :



WARRANTY

3 years on motors

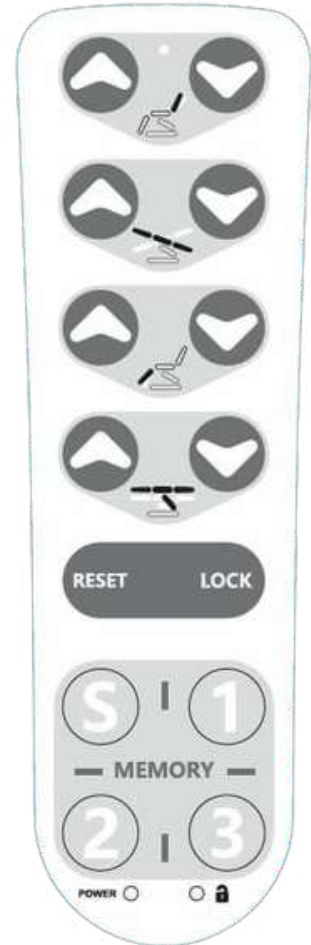

HANDSET

MEDICAL RECLINER CHAIR

PERFECT FOR INFUSION, ONCOLOGY, PHLEBOTOMY
AND DIALYSIS FACILITIES

Esthetica's newly introduced electrically operated clinical and medical recliner is thoughtfully engineered to address the varied needs of healthcare settings, offering a perfect balance of durability, comfort, and functionality. Ideal for use in IV Infusion, Oncology, Phlebotomy, Blood Collection and Dialysis centers, this recliner features a robust, powder-coated steel frame designed for reliability in demanding environments.



KEY FEATURES



Retractable Foot Tray

During oncology treatments, patients remain seated for long hours. A foot tray supports the feet, reduces pressure on the legs, and promotes a more ergonomic sitting posture, improving overall patient comfort.

Phthalate-Free Upholstery

Phthalate-Free Upholstery offers a safer, hospital-grade surface that resists stains, disinfectants, and abrasion, ensuring hygienic, durable, and eco-friendly performance across demanding clinical environments.

Comfortable Seating

Engineered with a 155 mm mixed-layer foam cushion that delivers superior pressure distribution and lasting comfort, even during prolonged treatment sessions like phlebotomy or infusion.

Detachable Side Armrests

The detachable side improves accessibility, safety, and transfer ease for patients with limited mobility. It allows one side of the recliner to open, enabling patients to sit from the side without climbing over the leg rest.



Cream



Beige



Brown



Mouse Grey

FEATURES

Armrests	Detachable Side Armrest for easy entry and exit from the chair
Footrest	Retractable Foot Tray
Castors	Smooth mobility with 3" lockable caster wheels
Foam Cushion	155 mm mixed layer of foams for comfortable seating

TECHNICAL SPECIFICATIONS

Length	1770 mm
Width	815 mm

ACCESSORIES

Stainless Steel IV pole Stand
Foldable Food Tray

ELECTRICAL PARAMETERS

Power in (Mains Power Supply)	100–240V, 50–60Hz 1.5A
IPX Rating	IPX6
Operating Temperature	10–40°C
Shock Protection:	Class I

BASE & FRAME

Base	Powder-coated mild steel frame
Safe Working Load	150 kgs
Patient Load Bearing capacity	125 kgs

SAFETY STANDARDS

General safety for medical electrical equipment	IEC 60601-1 (Underprocess)
EMI/EMC	IEC 60601-2 (Underprocess)

UPHOLSTERY

Type	Phthalate-Free Upholstery
Thickness	1.01 mm
Tensile Strength	ISO 1421, 804 N/ 5 cm
Colour Options	Cream, Beige, Brown, Mouse Grey
Weight	732 g / sqmt
Abrasion	ISO 5470-2 = 2,00,000 cycles / min

WARRANTY

1 years on motors



Powered by three robust motors, offers seamless adjustment of height, backrest and pelvis inclination for precise patient positioning. Crafted with patient comfort in mind, every detail, from the seat cushion to the footrests and headrest, ensures maximum comfort throughout the examination.

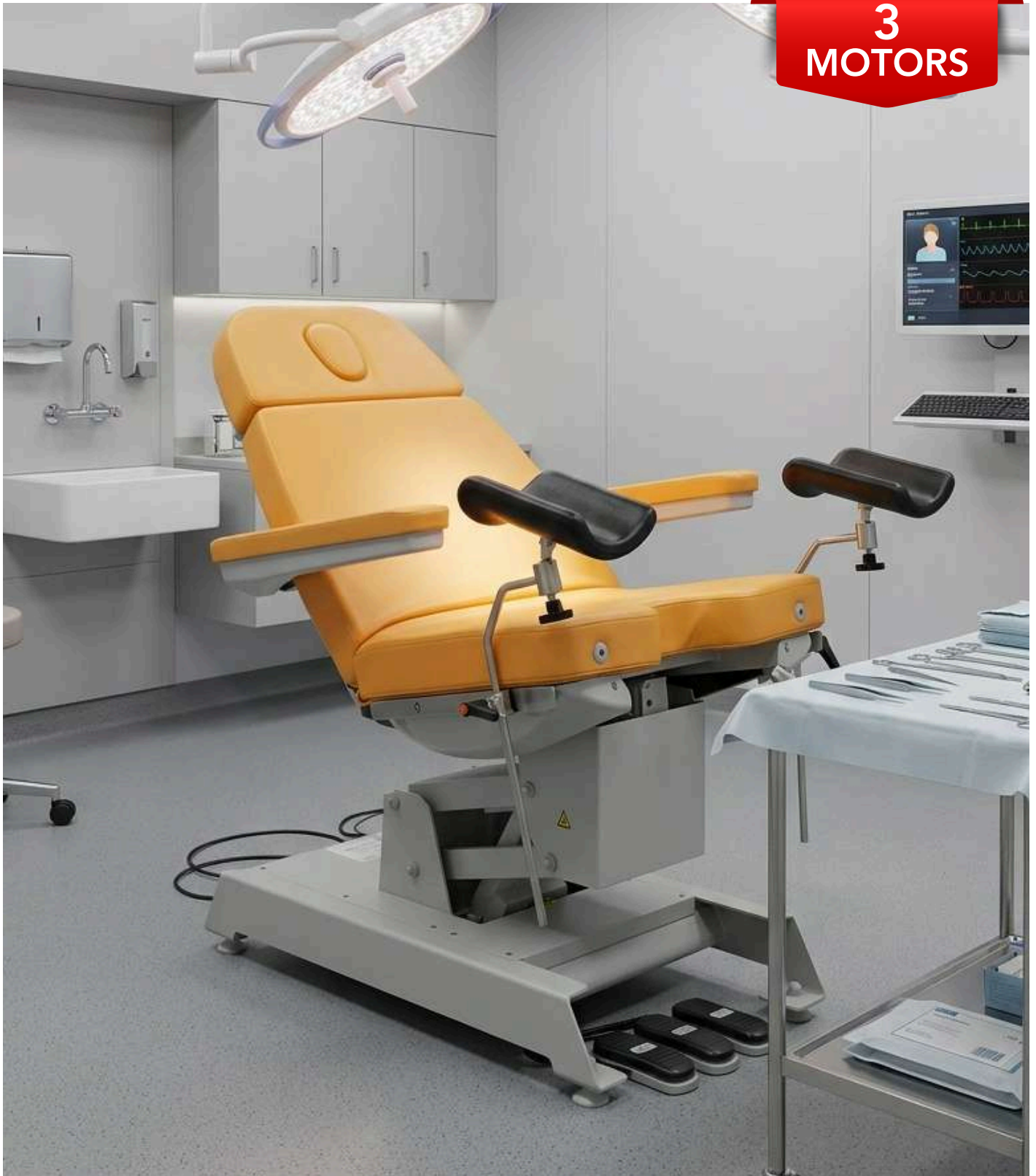

KEY FEATURES



Pelvic Tilt Feature

The pelvic tilt feature gently elevates and angles the patient's pelvis for optimal positioning during gynaecological examinations. It improves clinical access, visibility, patient positioning, and examination accuracy while ensuring proper anatomical alignment and comfort.

Phthalate-Free Upholstery

Phthalate-Free Upholstery offers a safer, hospital-grade surface that resists stains, disinfectants, and abrasion, ensuring hygienic, durable, and eco-friendly performance across demanding clinical environments.



Cream

Beige

Brown

Mouse Grey

LED Light

The detachable, touch-operated LED light provides bright, focused illumination for gynaecological examinations. Easily adjustable and removable, it enhances visibility, accuracy, and procedural efficiency while allowing hygienic operation, flexible positioning, and easy cleaning or maintenance.

Foot Controller

The foot control on a gynaecology chair allows hands-free, hygienic adjustments, enhancing workflow efficiency. It enables precise, quick chair positioning, reduces clinician strain, and maintains focus on patient care, offering convenience over handheld controllers.

FEATURES

Armrests	Detachable and Adjustable, with forward / backward movement
Backrest	Electronically Adjustable
Height	Electronically Adjustable
Pelvis Inclination	Electronically Adjustable
Foot-Controller	For Hands-free and Hygienic adjustments

TECHNICAL SPECIFICATIONS

Length	1990 mm
Width	940 mm
Minimum Height	615 mm
Maximum Height	870 mm

ACCESSORIES

Detachable Examination Light
Lithotomy Support

ELECTRICAL PARAMETERS

Power in (Mains Power Supply)	100-240 V, 50-60 HZ, 1.5A
IPX Rating	IPX6
Operating Temperature	10–40°C
Shock Protection:	Class I

BASE & FRAME

Base	Powder-coated mild steel frame
Safe Working Load	200 kgs
Patient Load Bearing capacity	150 kgs

SAFETY STANDARDS

General safety for medical electrical equipment	IEC 60601-1
EMI/EMC	IEC 60601-2

UPHOLSTERY

Type	Phthalate-Free Upholstery
Thickness	1.01 mm
Tensile Strength	ISO 1421, 804 N/ 5 cm
Colour Options	Cream, Beige, Brown, Mouse Grey
Weight	732 g / sqmt
Abrasion	ISO 5470-2 = 2,00,000 cycles / min

WARRANTY

3 years on motors



Manan 2-Section Medical Examination Table with electric height adjustment and gas spring adjustable backrest, designed for clinical examinations, laser and cosmetic treatments, with low height ensuring easy access and enhanced safety for elderly, overweight, and mobility-impaired patients.



KEY FEATURES



DIFFERENCE BETWEEN PRO AND BASIC MODEL

PRO MODEL

- **Walk Free Switch**

The Pro Model comes with a hands-free foot control system for height adjustments. It enhances hygiene, efficiency, ergonomics and can be operated from both sides. IEC 60601-1 safety requirement and IEC 60601-1-2 EMC standard complaint.

- **Easy Mobility**

The Pro Models have an easy mobility feature, which allows effortless repositioning of the treatment table within clinical environments. With a press of a lever, the table is lifted onto four wheels for smooth movement. When mobility is no longer required, the table can be securely fixed back on the ground for stability during procedures.

BASIC MODEL

- **Foot Switch**

Basic Model only comes with a wired foot controller for height adjustment by pressing the + or – symbols on the foot switch, as shown in the image below.



UPHOLSTERY

Phthalate-Free Upholstery

Phthalate-Free Upholstery offers a safer, hospital-grade surface that resists stains, disinfectants, and abrasion, ensuring hygienic, durable, and eco-friendly performance across demanding clinical environments.



FEATURES

Backrest	Manually Adjustable (Gas Spring)
Nose Slot	Helps the patient breathe freely in face down (prone position)
Height	Electronically Adjustable
Walk Free Switch	For Hands Free Height Adjustment
Easy Mobility	75 mm Castor Wheels for smooth movement

TECHNICAL SPECIFICATIONS

Length	2050 mm
Width	750 mm
Minimum Height	530 mm
Maximum Height	890 mm
Backrest Angles	-15° (when lowered) & 85° (when raised)

ELECTRICAL PARAMETERS

Power in (Mains Power Supply)	100-240 V, 50-60 HZ, 2A
IPX Rating	IPX4
Operating Temperature	5-40°C
Shock Protection:	Class I

BASE & FRAME

Base	Powder Coated Mild Steel
Safe Working Load	200 kgs
Patient Load Bearing capacity	150 kgs

SAFETY STANDARDS

General safety for medical electrical equipment	IEC 60601-1
EMI/EMC	IEC 60601-2

UPHOLSTERY

Type	Phthalate-Free Upholstery
Thickness	1.01 mm
Tensile Strength	ISO 1421, 804 N/ 5 cm
Colour Options	Cream, Beige, Brown, Mouse Grey
Weight	732 g / sqmt
Abrasion	ISO 5470-2 = 2,00,000 cycles / min

WARRANTY

3 years on motors



Mokshit 3 Section Treatment Table is thoughtfully designed to support patients in lying, sitting, and kyphosis positions. Featuring precision engineering, its gas spring-assisted backrest and legrest ensure smooth, comfortable adjustments tailored to individual patient needs.



KEY FEATURES



DIFFERENCE BETWEEN PRO AND BASIC MODEL

PRO MODEL

- **Walk Free Switch**

The Pro Model comes with a hands-free foot control system for height adjustments. It enhances hygiene, efficiency, ergonomics and can be operated from both sides. IEC 60601-1 safety requirement and IEC 60601-1-2 EMC standard compliant.

- **Easy Mobility**

The Pro Models have an easy mobility feature, which allows effortless repositioning of the treatment table within clinical environments. With a press of a lever, the table is lifted onto four wheels for smooth movement. When mobility is no longer required, the table can be securely fixed back on the ground for stability during procedures.

BASIC MODEL

- **Foot Switch**

Basic Model only comes with a wired foot controller for height adjustment by pressing the + or – symbols on the foot switch, as shown in the image below.



UPHOLSTERY

Phthalate-Free Upholstery

Phthalate-Free Upholstery offers a safer, hospital-grade surface that resists stains, disinfectants, and abrasion, ensuring hygienic, durable, and eco-friendly performance across demanding clinical environments.



FEATURES

Backrest	Manually Adjustable (Gas Spring)
Legrest	Manually Adjustable (Gas Spring)
Nose Slot	Helps the patient breathe freely in face down (prone position)
Height	Electronically Adjustable
Walk Free Switch	For Hands Free Height Adjustment
Easy Mobility	75 mm Castor Wheels for smooth movement

TECHNICAL SPECIFICATIONS

Length	2050 mm
Width	750 mm
Minimum Height	530 mm
Maximum Height	890 mm
Backrest Inclination	-15° (when lowered) & 80° (when raised)
Legrest Inclination	0° to -50° (when lowered)

ELECTRICAL PARAMETERS

Power in (Mains Power Supply)	100-240 V, 50-60 HZ, 2A
IPX Rating	IPX4
Operating Temperature	5-40°C
Shock Protection:	Class I

BASE & FRAME

Base	Powder Coated Mild Steel
Safe Working Load	200 kgs
Patient Load Bearing capacity	150 kgs

SAFETY STANDARDS

General safety for medical electrical equipment	IEC 60601-1
EMI/EMC	IEC 60601-2

UPHOLSTERY

Type	Phthalate-Free Upholstery
Thickness	1.01 mm
Tensile Strength	ISO 1421, 804 N/ 5 cm
Colour Options	Cream, Beige, Brown, Mouse Grey
Weight	732 g / sqmt
Abrasion	ISO 5470-2 = 2,00,000 cycles / min

WARRANTY

3 years on motors



Parth Physiotherapy Treatment Table is expertly crafted for versatile physiotherapy applications. Featuring lowerable armrests to ease neck and shoulder tension, plus gas spring-assisted backrest and headrest, it ensures effortless, comfortable positioning for patients and practitioners.



KEY FEATURES



DIFFERENCE BETWEEN PRO AND BASIC MODEL

PRO MODEL

- **Walk Free Switch**

The Pro Model comes with a hands-free foot control system for height adjustments. It enhances hygiene, efficiency, ergonomics and can be operated from both sides. IEC 60601-1 safety requirement and IEC 60601-1-2 EMC standard complaint.

- **Easy Mobility**

The Pro Models have an easy mobility feature, which allows effortless repositioning of the treatment table within clinical environments. With a press of a lever, the table is lifted onto four wheels for smooth movement. When mobility is no longer required, the table can be securely fixed back on the ground for stability during procedures.

BASIC MODEL

- **Foot Switch**

Basic Model only comes with a wired foot controller for height adjustment by pressing the + or – symbols on the foot switch, as shown in the image below.



UPHOLSTERY

Phthalate-Free Upholstery

Phthalate-Free Upholstery offers a safer, hospital-grade surface that resists stains, disinfectants, and abrasion, ensuring hygienic, durable, and eco-friendly performance across demanding clinical environments.



FEATURES

Backrest	Manually Adjustable (Gas Spring)
Armrest	Pneumatically lowerable armrests
Nose Slot	Helps the patient breathe freely in face down (prone position)
Height	Electronically Adjustable
Walk Free Switch	For Hands Free Height Adjustment
Easy Mobility	75 mm Castor Wheels for smooth movement

TECHNICAL SPECIFICATIONS

Length	1995 mm
Width	750 mm
Minimum Height	530 mm
Maximum Height	890 mm
Backrest Inclination	-15° (when lowered) & 80° (when raised)

ELECTRICAL PARAMETERS

Power in (Mains Power Supply)	100-240 V, 50-60 HZ, 2A
IPX Rating	IPX4
Operating Temperature	5-40°C
Shock Protection:	Class I

BASE & FRAME

Base	Powder Coated Mild Steel
Safe Working Load	200 kgs
Patient Load Bearing capacity	150 kgs

SAFETY STANDARDS

General safety for medical electrical equipment	IEC 60601-1
EMI/EMC	IEC 60601-2

UPHOLSTERY

Type	Phthalate-Free Upholstery
Thickness	1.01 mm
Tensile Strength	ISO 1421, 804 N/ 5 cm
Colour Options	Cream, Beige, Brown, Mouse Grey
Weight	732 g / sqmt
Abrasion	ISO 5470-2 = 2,00,000 cycles / min

WARRANTY

3 years on motors



Nirav 2 Section Treatment Table is meticulously designed with a short head section for precise manipulations. Easily adjustable, it allows optimal patient positioning and offers exceptional versatility for effective treatment of the neck and shoulder areas.



KEY FEATURES



DIFFERENCE BETWEEN PRO AND BASIC MODEL

PRO MODEL

- **Walk Free Switch**

The Pro Model comes with a hands-free foot control system for height adjustments. It enhances hygiene, efficiency, ergonomics and can be operated from both sides. IEC 60601-1 safety requirement and IEC 60601-1-2 EMC standard complaint.

- **Easy Mobility**

The Pro Models have an easy mobility feature, which allows effortless repositioning of the treatment table within clinical environments. With a press of a lever, the table is lifted onto four wheels for smooth movement. When mobility is no longer required, the table can be securely fixed back on the ground for stability during procedures.

BASIC MODEL

- **Foot Switch**

Basic Model only comes with a wired foot controller for height adjustment by pressing the + or – symbols on the foot switch, as shown in the image below.



UPHOLSTERY

Phthalate-Free Upholstery

Phthalate-Free Upholstery offers a safer, hospital-grade surface that resists stains, disinfectants, and abrasion, ensuring hygienic, durable, and eco-friendly performance across demanding clinical environments.



FEATURES

Backrest	Manually Adjustable (Gas Spring)
Nose Slot	Helps the patient breathe freely in face down (prone position)
Height	Electronically Adjustable
Walk Free Switch	For Hands Free Height Adjustment
Easy Mobility	75 mm Castor Wheels for smooth movement

TECHNICAL SPECIFICATIONS

Length	1980 mm
Width	750 mm
Minimum Height	530 mm
Maximum Height	890 mm
Backrest Inclination	32° (when raised)

ELECTRICAL PARAMETERS

Power in (Mains Power Supply)	100-240 V, 50-60 HZ, 2A
IPX Rating	IPX4
Operating Temperature	5-40°C
Shock Protection:	Class I

BASE & FRAME

Base	Powder Coated Mild Steel
Safe Working Load	200 kgs
Patient Load Bearing capacity	150 kgs

SAFETY STANDARDS

General safety for medical electrical equipment	IEC 60601-1
EMI/EMC	IEC 60601-2

UPHOLSTERY

Type	Phthalate-Free Upholstery
Thickness	1.01 mm
Tensile Strength	ISO 1421, 804 N/ 5 cm
Colour Options	Cream, Beige, Brown, Mouse Grey
Weight	732 g / sqmt
Abrasion	ISO 5470-2 = 2,00,000 cycles / min

WARRANTY

3 years on motors



The Aesthetic Bed by Esthetica is a versatile and professional treatment bed, designed to meet the needs of modern skin clinics, laser centers, and advanced spas. Combining smooth electric adjustments with ergonomic comfort, it provides therapists with precision and clients with ease and relaxation. Crafted with a durable powder-coated steel frame and upholstered in soft, skin-friendly fabric, the Aesthetic Bed blends functionality with refined aesthetics.



KEY FEATURES

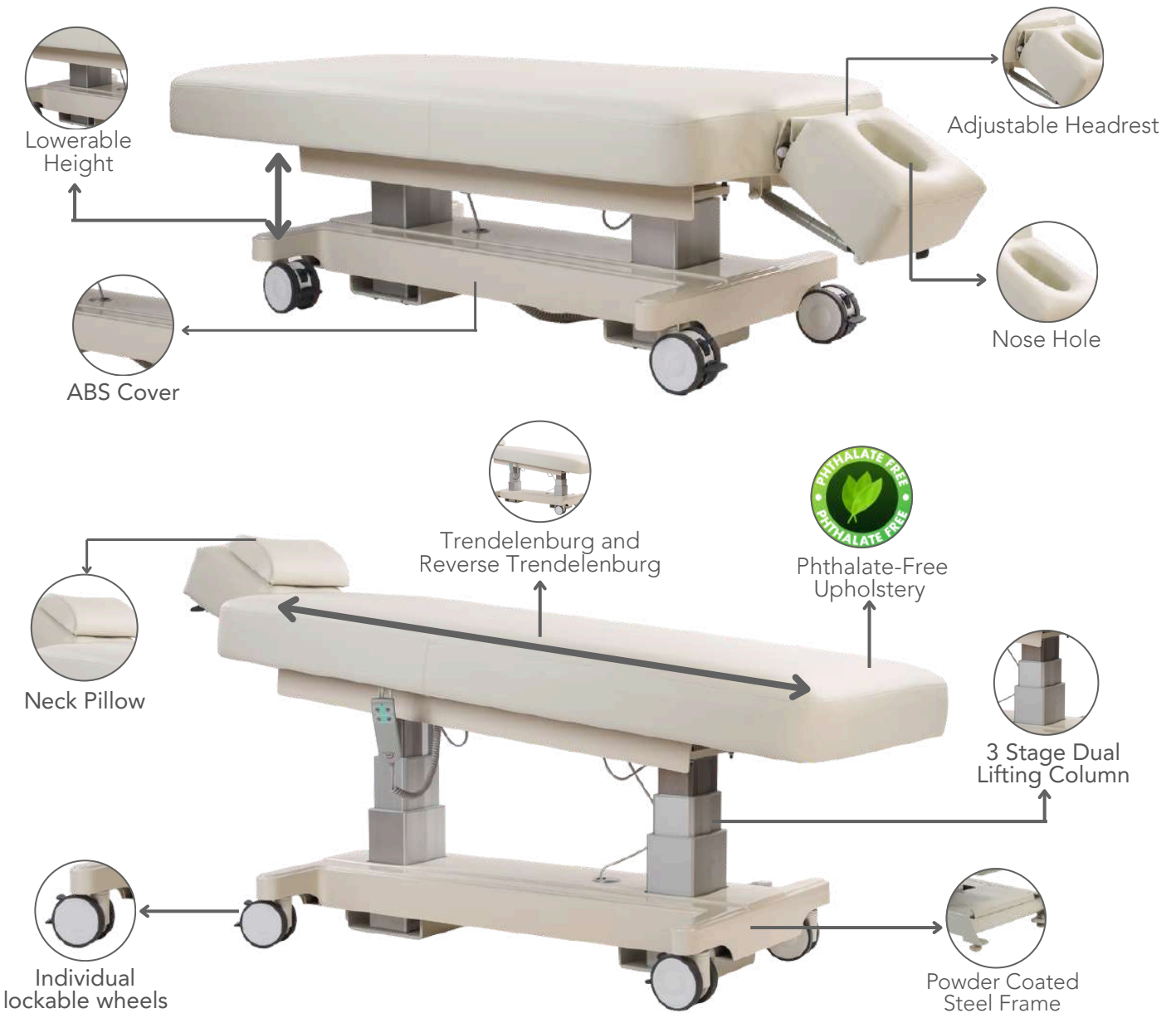

Trendelenburg Function

The Trendelenburg function tilts the bed head-down, improving facial blood circulation, enhancing treatment effectiveness, providing better practitioner access, ensuring client comfort and stability, and supporting procedures like facials and lymphatic drainage by aiding fluid movement.

Phthalate-Free Upholstery

Phthalate-Free Upholstery is designed for hospital environments, offering a safer surface for patients and healthcare workers. It resists stains and disinfectants, withstands frequent cleaning, and ensures durable, fire- and abrasion-resistant performance.

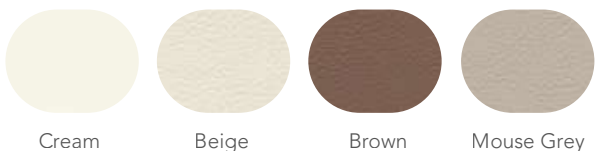

Adjustable Headrest

A tilting headrest can be raised or lowered, allowing upright or flat positioning for different treatments. It improves practitioner access and precision, enhances client comfort with proper neck support, increases bed versatility, and promotes easier breathing and relaxation during aesthetic procedures.

Easy Mobility

4-inch lockable castor wheels allow smooth movement of the aesthetic bed for easy positioning and cleaning, while locking ensures stability during treatments, enhancing safety, convenience, and flexibility in workspace arrangement without compromising client comfort or practitioner efficiency.

FEATURES

Headrest
Height
Trendelenburg
Castors Wheels

Reset Position

Electronically Adjustable
Manually Adjustable : +13° to -16° for treatment flexibility
Electronically Adjustable
4 x Individual lockable wheels



Reset

TECHNICAL SPECIFICATIONS

Length 2030 mm / 80 in
Width 800 mm / 31.49 in
Minimum Height 610 mm / 24 in
Maximum Height 990 mm / 39 in

ELECTRICAL PARAMETERS

Power in (Mains Power Supply) 100-240 V, 50-60HZ, 1.5 A
IPX Rating IPX 6
Operating Temperature 10-40°C
Shock Protection Class I

BASE & FRAME

Base Powder-coated mild steel frame
Safe Working Load 180 kgs
Patient Load Bearing capacity 150 kgs

SAFETY STANDARDS

General safety for medical electrical equipment IEC 60601-1 (under process)
EMI/EMC IEC 60601-2 (under process)

UPHOLSTERY

Type Veridura Phthalate-Free Upholstery
Thickness 1 mm
Tensile Strength ISO 1421, 869.22 N/ 5 cm
Colour Options Cream, Beige, Brown, Mouse Grey
Weight 726.7 g / sqmt
Abrasion ISO 5470-2 = 2,00,000 cycles / min

Features :



Phthalate-Free



Fire Retardant



Oil Resistant



Alcohol Resistant



Ultra Soft



Stain Resistant



Anti Bacterial



Eco-Friendly

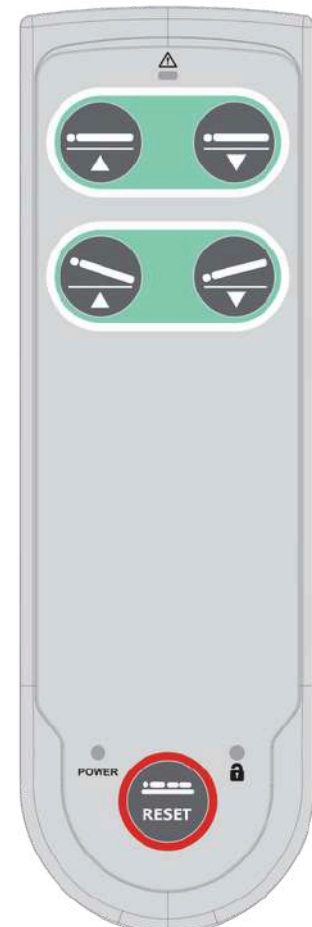

HANDSET

WARRANTY

3 years on motors